

BASIC SIGNALLING DEVICE ø200 SP200



Compliance with:

PN-EN 12352

L8H

- L8H; P0; C1; R0; A0; I0; F3; O1; M3; T1; S0

Characteristic:

Basic signalling device SP200 has many applications (draw no 1). Using high LED technology makes low power consumption and longer life of light source. It eliminates phantom effect. In depend on type the device can work as a autonomous element or external command by master unit. Device is adjusted to be powered with solar panel.

Technical data:

Light source:	LED
Light source life:	≥ 10 years
Luminous intensity:	1850 cd
Emitting signal colour:	yellow, red, green, white, blue
Impulse frequency:	50±3 / min (or external command)
Power consumption @ 12V:	
steady daylight:	0,69A
steady night:	0,30A
Overall dimensions:	
diameter:	200 mm
thickness:	65 mm
Weight:	0,4 kg

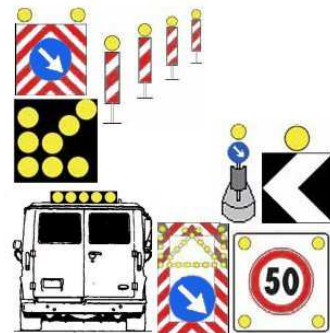

Draw no 1

Types

SP200-0111	yellow basic signalling device, external command, supply 12V.
SP200-0121	yellow basic signalling device, external command, supply 24V.
SP200-0112	yellow basic signalling device, internal command, supply 12V
SP200-0132	yellow basic signalling device, internal command, supply 12/24V
SP200-0133	yellow double synchro flashing basic signalling devices, supply 12/24V
SP200-0134	yellow double alternating flashing basic signalling devices, supply 12/24V
SP200-0113	yellow double synchro flashing basic signalling devices, supply 12V
SP200-0114	yellow double alternating flashing basic signalling devices, supply 12V
SP200-0115	yellow basic signalling device, internal command, for solar panel
SP200-0116	yellow double synchro flashing basic signalling devices, for solar panel
SP200-0212	red basic signalling device, internal command, supply 12V
SP200-0312	green basic signalling device, internal command, supply 12V